

Door Trim Panel

Removal

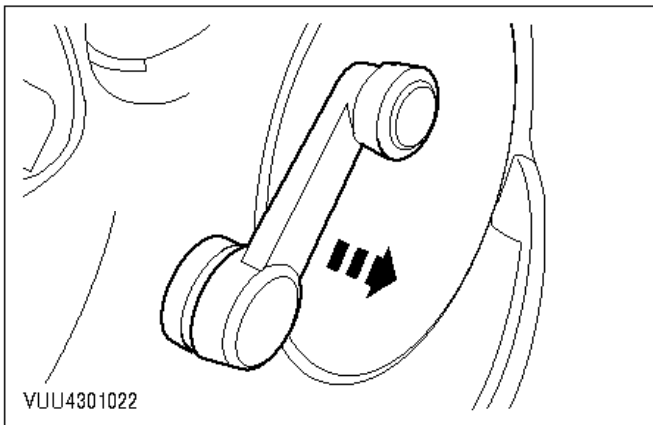

Vehicles without power windows

- μ 1. Remove the window regulator handle.

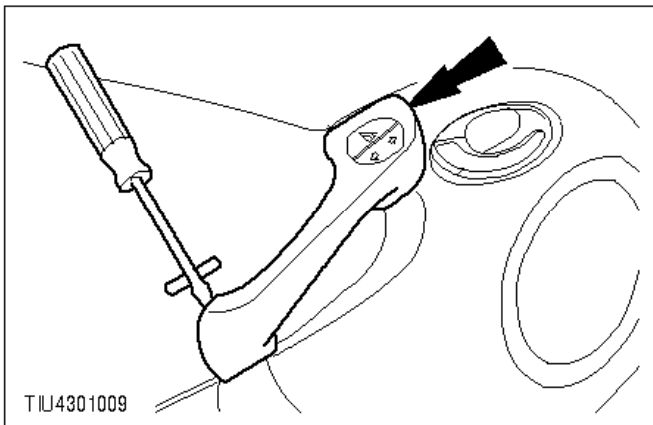

Vehicles with power windows

- μ 2. Prise off the door pull handle.

- Use a pad between the screwdriver and surround to prevent damage.

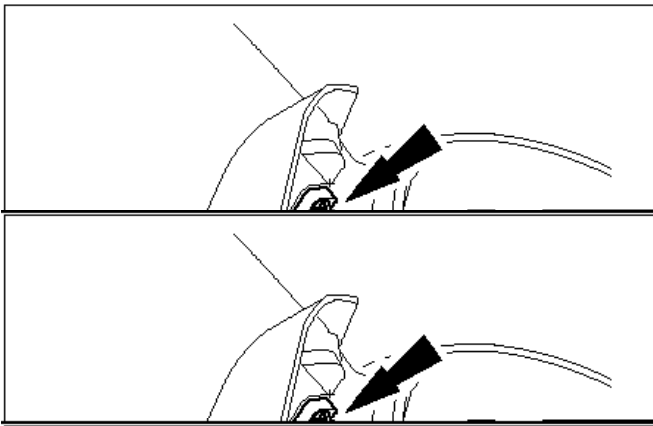

- μ 3. Disconnect the power window switch multiplug.

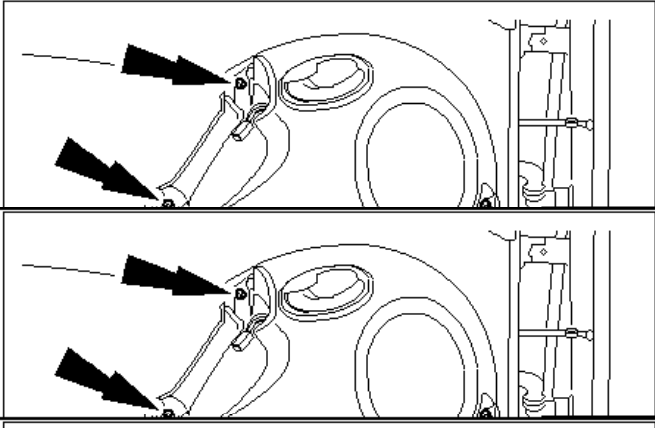

All vehicles

- μ 4. Remove the front door trim panel retaining screws.

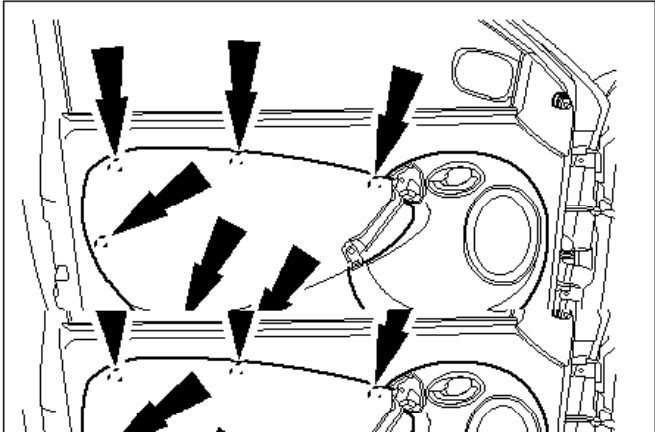

- μ 5. Remove the front door trim panel (eight clips).

Installation

1. Refit the components in reverse order.
 - When refitting the manual window regulator handle, ensure that the handle is aligned with the door pull.
-